



www.claypaky.it



ALPHA 700

Profile | Spot HPE | Beam | Wash

ENGLISH

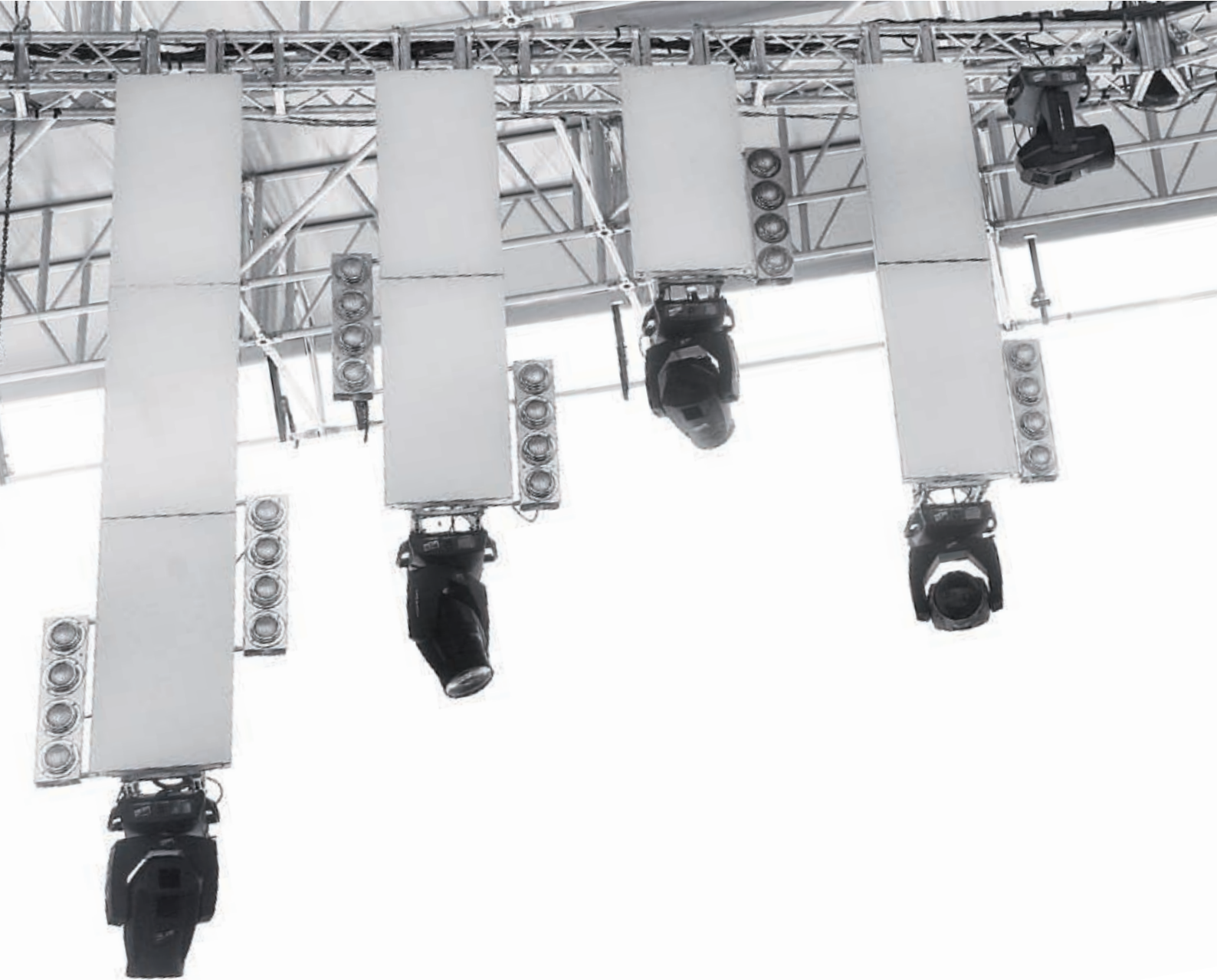

Alpha Profile 700



Alpha Spot HPE 700



Alpha Beam 700



Alpha Wash 700

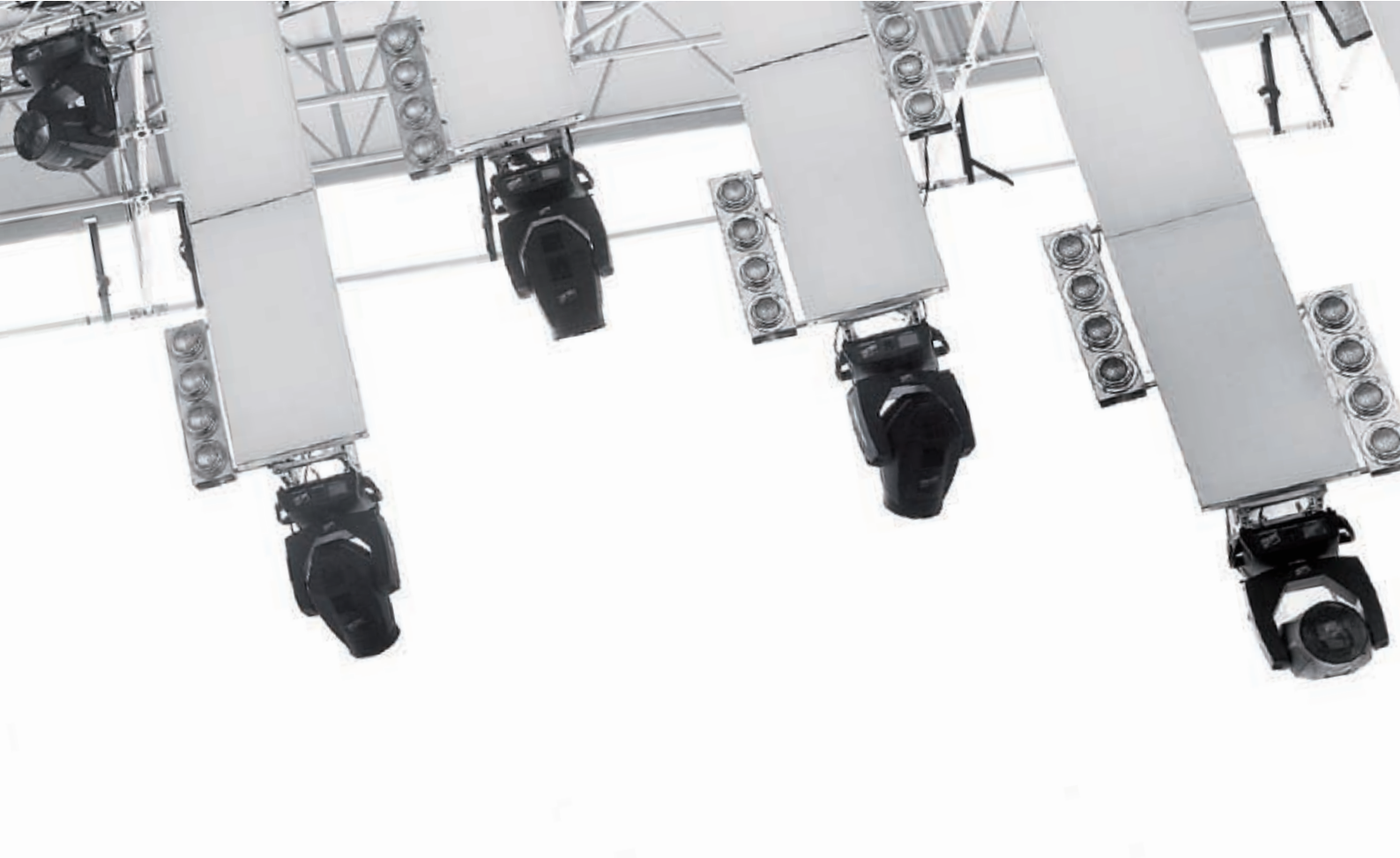

Alpha 700: where emotion and reason converge

For many years, new lights were mainly chosen for their novelty value, in other words their ability to arouse emotions owing to new functions and increased performances.

Today however moving head lights are mature products, most of their functions have been standardized, new effects are increasingly marginal and they are less and less likely to seduce users, who are in turn ever more aware of and attentive towards substance.

Clay Paky's rational response to this mature market are the new Alphas 700, the result of meticulous engineering that puts consolidated user requirements in the foreground.

The Alpha 700 moving heads are the epitome of the most advanced technologies in every field. Precision micromechanics and optics, powerful reliable electronics, advanced lighting engineering and an ergonomic and pleasant design all converge to create a family of compact professional lights that fascinate for the rationality of the solutions adopted and the way they improve technical practice.

However Clay Paky Alphas 700 are not just the perfect rational option. They also fully satisfy the requirements of an emotional choice. Ease of use comes with a surprising range of powerful functions, with no compromises. The small body of the Alpha 700 is a precious magic box from which an unexpectedly bright light emerges with a range of effects and controllability that can only be found in the most powerful and expensive latest generation lights.

The Alphas 700 are the most modern luminaires on the lighting market today. They are rationally designed and built to create emotion in all fields of entertainment.

Our Stage

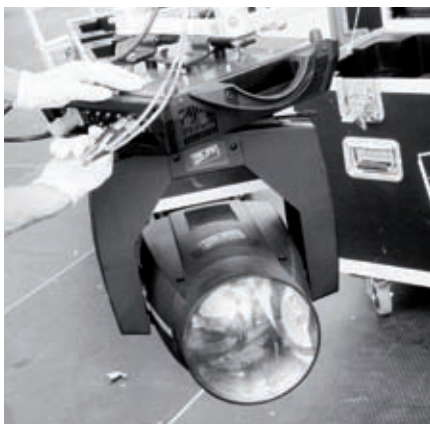





Smallest and lightest

Alphas 700 are the smallest and lightest-weight 700 watt lights in the world. They weigh only about 20 kg (44 lbs) and their moving head is just 40 centimeters in size. These features originate countless benefits, on all levels. They are extremely easy to handle on stages, to lift and install. They take up very little space on trucks and in the warehouse. Thanks to limited space and weight engaged, they leave room for other equipment on trusses and make rigging easier. All Alphas 700 (spot, wash and beam) use the same flight case, which is identical to the Clay Paky Alpha 300 case, another advantage during stage break down and stock handling.



Latest generation electronics

The electronics are totally new, with state-of-the-art components, firmware and modular construction. They enhance mechanical performance and improve ease of use. The user can access a full menu through a large display, including: preset macros; an "energy saving" function; remote lamp on/off control; function reset controllable from the lighting desk "autotest" function; Ethernet ready; electronic effect adjustments. The electronics automatically monitor operating parameters and report levels and faults on the display: DMX signal level on each channel, internal temperature, internal control data transmission and encoder and sensor status. A cut-out system switches the unit off in the event of overheating. Thanks to a buffer battery, the configuration display can be operated also without connecting the light to a power line, even when it is still in the flight-case. The user may perform a complete set-up, assign the address and update the firmware by downloading the new version from an uploader or directly from another fixture. The electronic circuit board is universal for all Alpha 700 versions and its function may be defined by the user through the display. There is also only one firmware that runs all versions.

Five reasons for a rational choice



Extraordinarily versatile

Their exceptional brightness, the incomparable speed of their movements, their wide range of effects, the richness of their color system and the silence of their operation are the features that make Alphas 700 ideal for use in television studios, theatres, corporate events, concerts and on tours, and both for large and small rental companies. In all these applications, as in fixed installations, small size and light weight are considerable advantages.



Operating cost saving and sustainability

These 700 watt luminaires with the light output challenging a 1200 watt unit can be run at 400 watts when need be. In addition to their lightweight and small size, they have a modular construction that makes maintenance easier. They are suitable for all kind of shows. Their performance/price ratio is optimal. All these features together mean lower investments, lower running costs, energy saving and respect for the environment, with - what is more - no compromise in terms of luminous efficacy and with the full emotional impact in the light show.



Extremely easy to use and maintain

Every single feature of the Alpha 700 is designed and engineered bearing in mind the real needs of users at all levels. Riggers, roadies and carriers will be enthusiastic about their ease of handling. Technicians and lighting operators will be seduced by their simplicity of use. The thousands of possible effects will fascinate lighting designers. Maintenance staff will benefit enormously from their constructional standardization and modularity. Lastly accountants will be their first supporters thanks to their cost and management benefits.

Performance

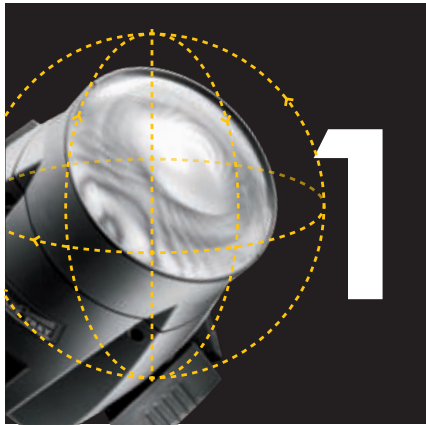

Fast, very fast, the fastest!

The faster the moving light, the more exciting the show, and Alphas 700 have no match in this. Their speed is staggering, their acceleration virtually instantaneous and their movements are meticulously precise and perfectly repeatable. This performance is possible thanks to new electronics together with perfect micromechanics, which only Clay Paky can offer. The three-phase motors respond promptly to control signals, giving rise to breathtaking changes in direction. The agility of their movement is enhanced by the small size of their head. Color and gobo changes, prism rotation, zoom changes and strobe effects take place with the same spectacular rapidity. Changes from one level to another are undetectable and sixteen-bit resolution guarantees great accuracy.



Silence comes as standard

An Alpha 700's mechanical movements are totally silent at any speed! That goes for all motorized functions and not just pan and tilt: gobo, color and zoom changes, rotating effects and even extremely high frequency strobe flashing. Cooling fan noise is only 42 dB in the case of the Profile model and 47.5 dB in the case of the others. This level drops further when the internal temperature decreases, for example when the lamp is dimmed, since internal sensors automatically reduce fan speed. If you need almost total silence, just choose 400 Watt mode: the fans run at minimum and generate 40dB in the case of the Profile and 46 db in the case of the other models. The quietness of Alphas 700 is perfect for theatres, television studios and other applications where silence is a crucial requirement.

Five reasons for an emotional choice



700 watts that are worth much more

The very small-bodied Alphas 700 generate light beams that beat all competitors of the same power and often exceed lights with much higher rated powers. The legendary superiority of Clay Paky optics is evident in the Alpha 700's complete, accurate, versatile, powerful optical system. Its efficiency is optimized by superior quality optical components, including a dichroic elliptical reflector that enhances the whole luminous flux emitted by the lamp. This light source is an exclusive quick-release Mini FastFit lamp, made specifically for these luminaires according to specifications drawn up by the Clay Paky R&D team. The optical system allows the user to choose between a highly concentrated beam, suitable for bright light projection and mid-air effects, and a wider more uniform light.



All the effects you need to decorate, amaze and entertain

There is nothing Alphas 700 cannot do. Every version is enhanced with functions normally found only on the most expensive fixtures. The spot and wash lights have a long zoom range, electronic dimmer and frost filter. The graphic tools are the best you could wish for: all gobos are combinable and made of pure dichroic glass; the rotating prism multiplies the beam creating beautiful effects, and the iris is ultra-fast. Alpha Beams 700 are not just automated ACLs, since they create both astounding mid-air effects and rather effective long-distance graphical projections. You do not have to make compromises if you choose an Alpha 700!

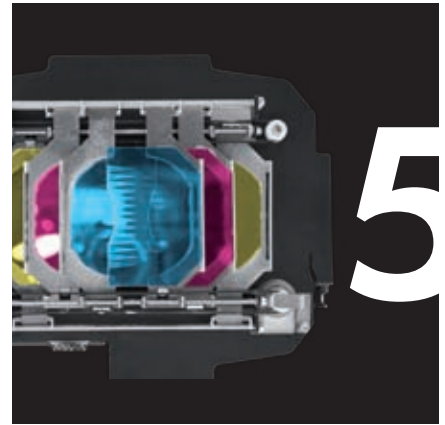

Rich colors for any mood

At the heart of each Alpha 700 is the system that colors the light beam, capable of creating a wide range of rich and pastel colors for which Clay Paky has always been famous. The system is based on CMY subtractive color mixing, with dichroic filters selected to cover a large area of the color spectrum. An additional wheel, with eight extremely pure colors plus white, provides special hues frequently required in professional lighting. The change from one color to another is instantaneous; color temperature adjustment is possible thanks to special filters.



Deep Purple



Pooh tour 2009



Ferrari World Grand Opening
in Abu Dhabi, UAE



Friday Night with Jonathan Ross
(feat. Shakira), UK



2011 Sanremo Festival, Italy



ALPHA PROFILE 700

Code C61365

The Alpha Profile 700 is the only 700W automated spotlight with framing system available on the market today. Fitted with a Philips Mini-Fast-Fit discharge lamp, it offers a light output comparable to a regular 1200W fixture. The stand-out feature of the Alpha Profile 700 is its excellent optical group with 7.6°- 55° zoom and perfectly even projection field. The impressive (patent-pending) 'Stay-Sharp-Zoom' function keeps images in continuous focus while zooming from one beam angle to another, even when projected effects are located on different focal planes. The focal distances have been optimized, so both the edges of the beam blades and the projected image remain perfectly in focus at the same time if required. Programming is enormously simplified, thanks to the colour macros and the Dyna-Cue-Creator function, which enables endless combinations of editable graphic effects.

Endless shaping solutions

The Alpha Profile 700 framing system is one of the most advanced beam-shaping devices on the market today. With four independent overlapping blades, designers can now create all manner of triangles and quadrangles of any shape or size. Thanks to a sophisticated micro-mechanical design, the framed edge of the image remains sharply in focus at the same time as the projected image itself. The exclusive 'curtain effect' (patented) allows gradual total closure of the shape using any one of the four blades. The whole shape may also be rotated up to 90°, either to change its orientation or to keep it fixed as the light beam moves. All movements are smooth and the speed may be adjusted as required.

Precision linear zoom and dimmer

The Alpha Profile 700 has a very fast zoom with a surprisingly wide aperture range from 11° to 55° (7.6° in extra-run). The dimmer is electronic from 100 to 50% and mechanical from 50% to zero. The dimming curve may be set from a menu. Electronic dimming also leads to energy savings and longer lamp life. Sixteen-bit resolution ensures extra-precise linear control of both functions.

The Stay-Sharp-Zoom: a dream comes true

The Alpha Profile 700 features a 'Stay Sharp Zoom' device that keeps images in continuous focus while zooming from one beam angle to another, even when projected effects are located on differ-

ent focal planes. The Stay Sharp Zoom device can be turned on and off as required, operating in the range from 11° to 55°, where the zoom is linear. Thanks to this innovative, timesaving function, programming becomes far simpler: a sophisticated algorithm instantaneously and automatically repositions every single lens in the array according to the new zoom beam angle.

Dyna-Cue-Creator

The Dyna-Cue-Creator function provides a library of dynamic - often three-dimensional - animations that lighting designers find easy to use in their shows. The Dyna-Cue-Creator is the result of meticulous artistic research: the zoom, focus, iris and dimmer functions are combined and synchronized in ways that may be customized by lighting designers (and further combined with colours, gobos, speed and other effects). This is made possible due to the autofocus' extremely rapid and constant adjustments; lighting designers no longer have to program continuous focus corrections with benefits that are particularly evident in complex cues, where the gobo, focus and zoom angles change simultaneously. The 'macros' can be assigned either to individual projectors or applied to groups of projectors. In automatic mode, groups of projectors can be set to play the same macro in a phased sequence - with no need to set the phase shifts manually, as synchronization is controlled automatically by the projector and not from the console.

Select pure colours

The built-in CMY colour mixing system and additional colour wheel (8+white) make it possible to obtain any colour. New special colours - particularly sought after in professional use - have been selected for the colour wheel.

A range of high quality graphic functions

The Alpha Profile 700 offers a range of effects that make the light suitable for any creative need: 7 interchangeable rotating gobos in dichroic glass, a frost filter which simulates a wash light effect, and a very fast iris, that in addition to changing the beam diameter, can be used as an impressive effect itself.

Silence! This is theatre

Alpha Profile 700 has exactly what theatre lighting designers require: an excellent zoom, a versatile shutter system, a full-spectrum colour-engine, a small and lightweight body, 16-bit resolution accuracy. Furthermore it is the most silent of all the Alpha fixtures: mechanical movements are totally quiet while the noise generated by cooling fans is as low as 42 dB (40 dB in the energy-saving mode).

CONTROL CHANNELS

- | | | |
|--------------------------|-----------------------------|-------------------|
| 01. Cyan | 17. Blade UP2 | 33. Tilt |
| 02. Magenta | 18. Blade DN1 | 34. Tilt fine |
| 03. Yellow | 19. Blade DN2 | 35. Function |
| 04. Linear CTO | 20. Blade RG1 | 36. Reset |
| 05. Color Wheel | 21. Blade RG2 | 37. Lamp control |
| 06. Color Macro | 22. Blade LF1 | 38. Pan-Tilt Time |
| 07. Stop/Strobe | 23. Blade LF2 | 39. Color Time |
| 08. Dimmer | 24. Framing System Rotation | 40. Beam Time |
| 09. Dimmer fine | 25. Focus | 41. Gobo Time |
| 10. Iris | 26. Focus fine | |
| 11. Rotating Gobo Change | 27. Zoom | |
| 12. Gobo Rotation | 28. Autofocus distance | |
| 13. Gobo fine | 29. Autofocus adjustment | |
| 14. Prism | 30. Macro effects | |
| 15. Frost | 31. Pan | |
| 16. Blade UP1 | 32. Pan fine | |

WEIGHT AND DIMENSIONS (mm - inches)

31,5 Kg (69 lbs 5 oz)

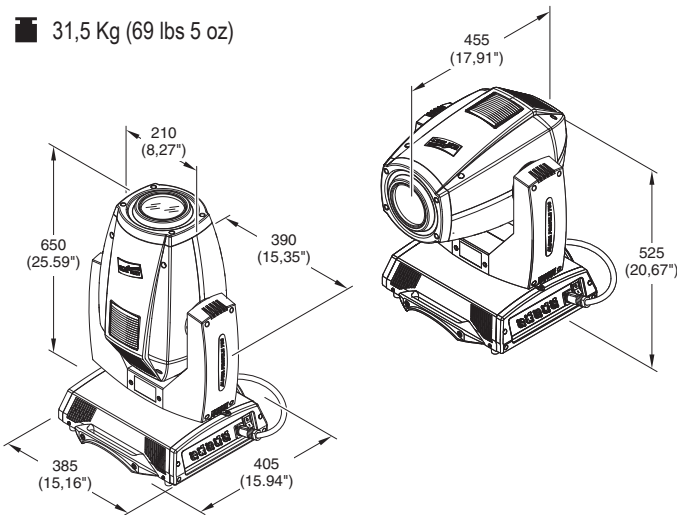

ROTATING GOBOS Ø 25.7 mm, image Ø 23.5 mm

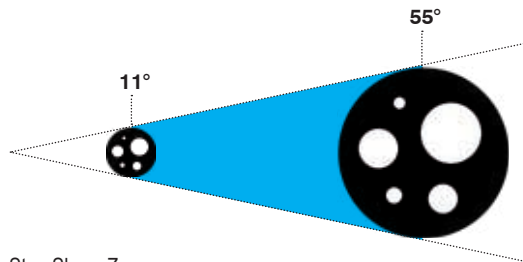

Stay-Sharp-Zoom:
the operator no longer has to worry about losing the sharpness of the projection.

PHOTOMETRICS

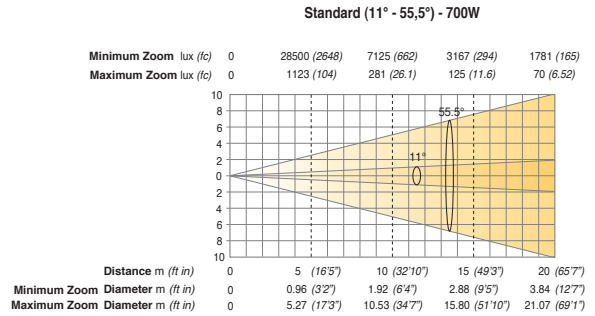

In "Half-Power mode" the luminosity is 55% of the above values

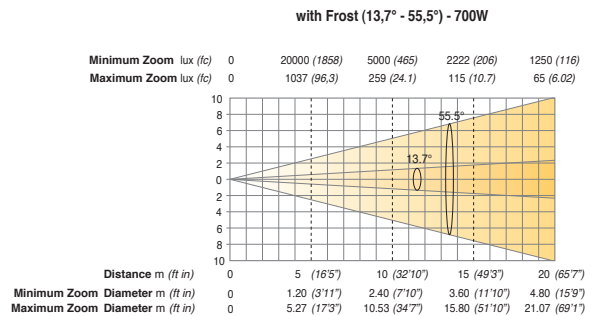

In "Half-Power mode" the luminosity is 54% of the above values

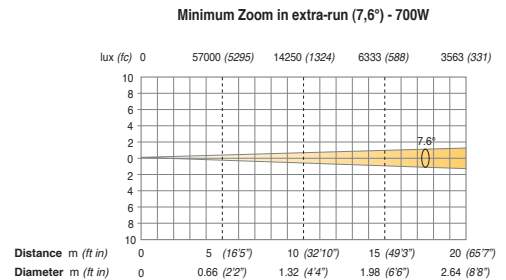

In "Half-Power mode" the luminosity is 53% of the above values

COLOR WHEEL

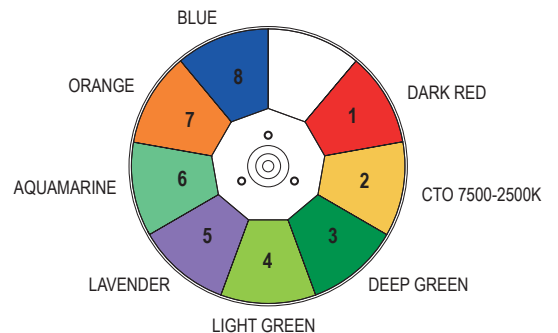

FRAMING SYSTEM

framing system rotation on 90°

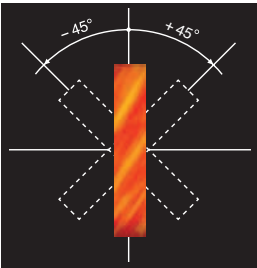

Alpha Profile 700 features a precision micromechanics framing system that ensures perfect repeatability and does away with continuous manual adjustments.

	square	rectangle	diamond
triangle	slice	curtain 1	half circle
open curtain	closed curtain	ribbon	square-corner trapezium
			trapezium

DYNA CUE CREATOR

The "Dyna-Cue-Creator" function opens doors for lighting designers to a universe of spectacular, creative solutions.

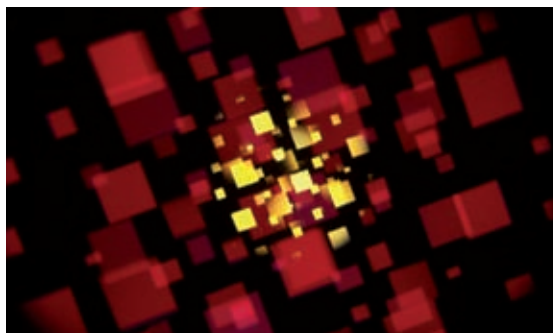
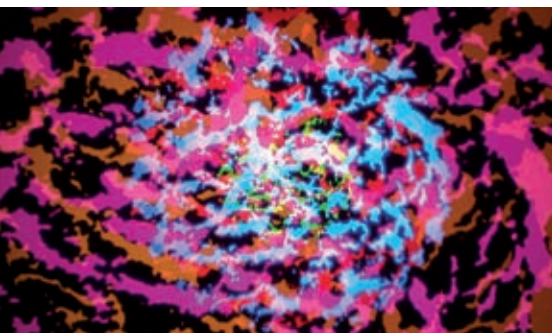
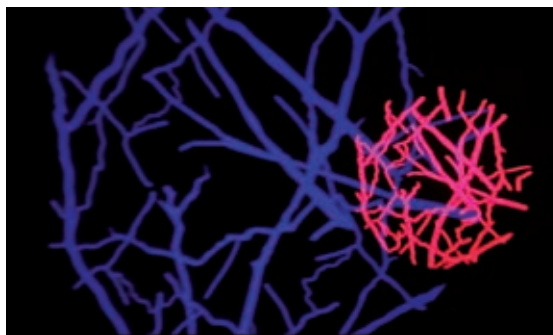
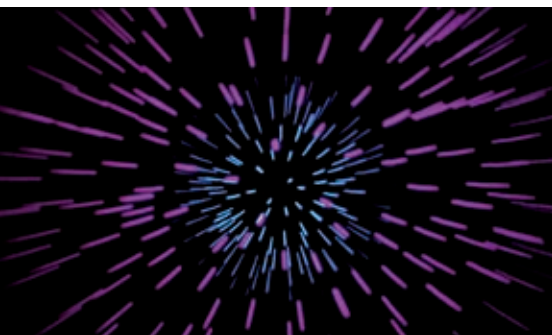



ALPHA SPOT HPE 700

Code C61355

With the Alpha Spot HPE 700, a new generation of “moving heads” for graphic effects is born. This luminaire combines spectacular effects, ease of daily use, simple operation and environmental sustainability. The 700 watt lamp provides a level of brightness equal, if not greater, than that seen with higher wattages. The small and light-weight body houses an array of optical and graphic devices that have nothing to envy from more sophisticated fixtures, including a zoom with electronic focus and electronic dimmer. The frost effect and its extraordinary brightness allow this spotlight to be used in the place of a washlight. The keywords for Alpha Spot HPE 700 are: full beam control, complete range of graphic effects, brightness, speed, low energy consumption and versatile use.

A light beam making all graphic effects sharp and bright

Decorative projection is without a doubt more impressive when images are bright their edges clear and well defined. For this purpose, the Alpha Spots HPE 700 feature a special optical system and dichroic elliptical reflector with high luminous efficiency that collect and concentrate the flux emitted by the new FastFit 700W lamp, intentionally creating a “hot-spot” effect with no less than 33,000 lx at five meters. However, if necessary, a separate lens can be inserted to soften the beam with a more “uniform field”, for example in less brightly lit scenes.

Breathtaking speed

The Alpha Spot HPE 700 is as nervous as a colt. This spotlight has been designed to amaze for the agility of its movements and the readiness with which it responds to controls. The incomparable speed of the three-phase motors is used to the full in this version. Not only do they produce extremely fast pans (2.75 s / 540°) and tilts (1.65 s / 250°), but also instantaneous “snapshot” transitions from one effect to another (gobo, iris and zoom) and impressive bi-directional rotations (prisms and gobos). Furthermore sixteen-bit resolution guarantees absolute precision and reproducibility.

Precision linear zoom and dimmer

Alpha Spots HPE 700 have a very fast linear zoom with wide linear range from 14.7° to 47°. The dimmer is electronic from 100 to 50% and mechanical from 50% to zero, and is perfectly linear. Electronic dimming leads to savings in consumption and longer lamp life. Sixteen-bit resolution ensures extra-precise control.

Beautiful colors

The built-in CMY system and the additional color wheel (8+white) make any color possible. Special new colors, particularly demanded for professional use, have been selected for the color wheel.

High quality devices for projections and mid-air effects

Despite their small size, Alpha Spots HPE 700s provide a vast range of effects, able to satisfy every creative requirement. Their fifteen interchangeable gobos (seven rotating plus eight fixed) are all made from high quality textured dichroic glass, and fitted on two wheels that can be combined for a high impact morphing effect. The highly transparent rotating prism allows fairly large surfaces to be decorated with dynamic and highly atmospheric effects. The frost filter is so effective that it emulates a washlight. Finally the iris is so fast that it can be used as an effect in its own right.

	5m	10m	15m	20m
■ Alpha Spot HPE 700	33,000	8,250	3,667	2,063
● Alpha Spot HPE 1200	24,700	6,150	2,744	1,543
▲ Alpha Spot HPE 575	9,233	2,308	1,026	577

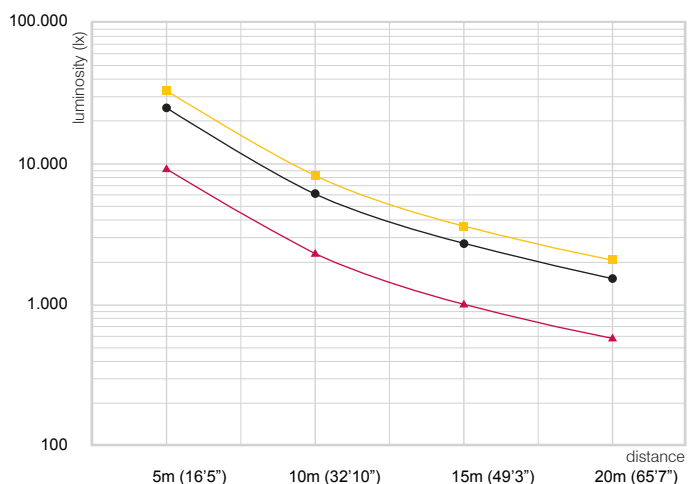

Luminosity at the centre of the beam for 3 Alpha Spot HPE models according to distance (14.7° aperture)

CONTROL CHANNELS

- | | |
|--------------------------|-------------------|
| 01. Cyan | 16. Frost |
| 02. Magenta | 17. Focus |
| 03. Yellow | 18. Linear Zoom |
| 04. Uniform field lens | 19. Pan |
| 05. Color Wheel | 20. Pan Fine |
| 06. Stop/Strobe | 21. Tilt |
| 07. Dimmer 0-100% | 22. Tilt Fine |
| 08. Dimmer Fine | 23. Function |
| 09. Iris | 24. Reset |
| 10. Static Gobo Change | 25. Lamp control |
| 11. Rotating Gobo Change | 26. Pan-Tilt Time |
| 12. Gobo rotation | 27. Color Time |
| 13. Gobo Fine | 28. Beam Time |
| 14. Prism | 29. Gobo Time |
| 15. Prism rotation | |

WEIGHT AND DIMENSIONS (mm - inches)

■ 22,9 Kg (50 lbs 6 ozs)

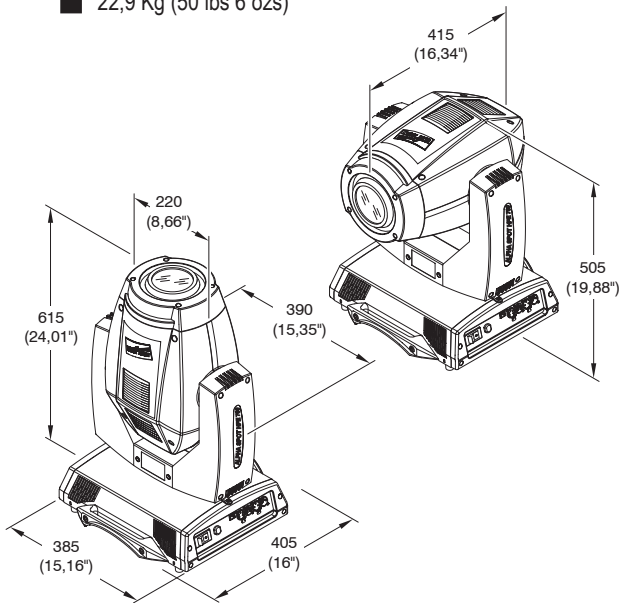

PHOTOMETRICS

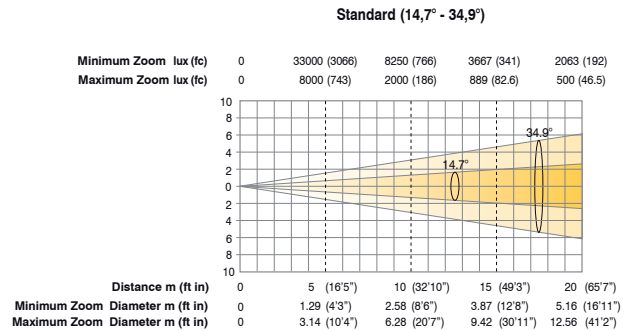

In "Half-Power mode" the luminosity is 53% of the above values

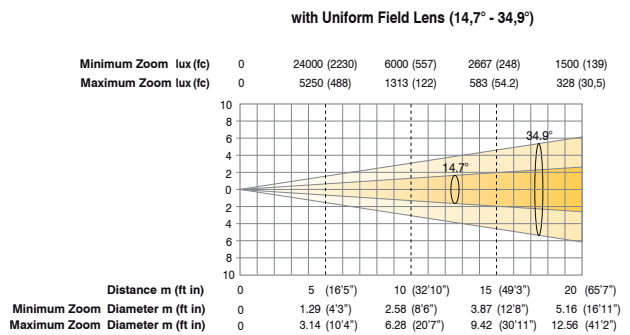

In "Half-Power mode" the luminosity is 51% of the above values

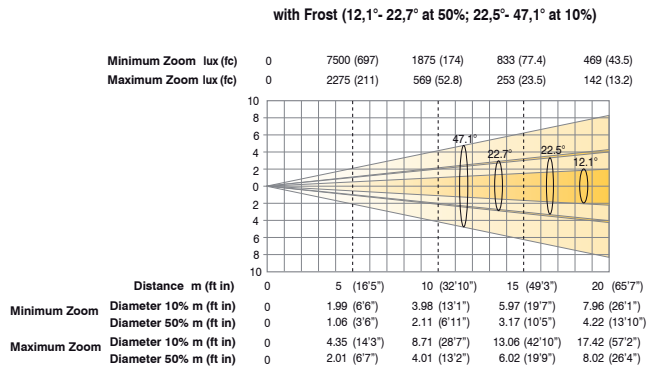

In "Half-Power mode" the luminosity is 45% of the above values

Diameter 10%-50%: beam diameter for 10% and 50% of maximum illumination.

STATIC GOBOS

Ø 31.5 mm, image Ø 23 mm



ROTATING GOBOS

Ø 25.7 mm, image Ø 23 mm



COLOR WHEEL

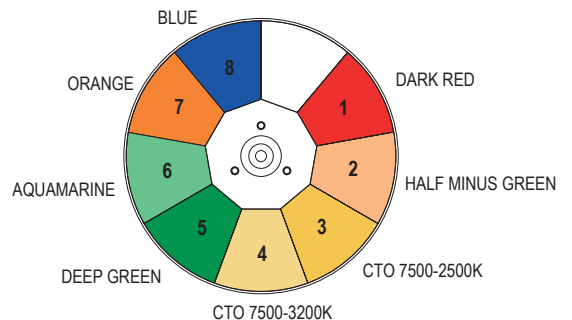

ALPHA 700

Profile | Spot HPE | Beam | Wash



small



ALPHA BEAM 700

Code C61360

The Alpha Beam 700 is a special unique luminaire, conceived as an automated ACL to create parallel light beams visible even in the brightest scenes. However its extensive range of effects makes it the most versatile of the Alphas 700. First and foremost, thanks to its rotary gobos and prism, it generates extremely bright beams with amazing dynamic mid-air effects. At the same time, its high quality optical components with focusing can project sharp gobo patterns even at long distances. Lastly, its frost filter can transform the Alpha Beam 700 into an extremely efficient washlight able to “reinforce” other color changers. Its beam can be moved extremely fast on the stage, on the audience and into the sky during open air events. It can be an exciting blinder or a striking dynamic color-changing sky-tracker.

A concentrated beam with never-seen-before brightness

This small luminaire, fitted with a 700 watt only lamp, produces a light beam that is so concentrated and powerful it leaves you stunned: 100,000 lx at ten meters! The beam reaches several hundred meters with its 6.6° aperture, and is visible at great distances. It stands out from any background, even when there are powerful video screens or other extremely bright equipment on stage.

Incredible versatility

Alpha Beams 700 may be used perfectly well as real spotlights with fixed or rotating images. They are particularly suitable for projecting images at considerable distances. The fixtures are equipped with electronic focusing for sharp and clear projection, with or without rotating prism. They are also fitted with a linear frost effect created with special micro-lenses; when this frost effect is used on a simple colored light beam, a perfectly uniform field is achieved that has nothing to envy

from a specialized washlight.

An incomparable number of spectacular mid-air effects

Seven rotating and eight fixed gobos (all interchangeable) with carefully chosen patterns mean the shape of the light beam can be “molded” to taste. The iris does not only adjust the beam diameter, but adds a further effect to the show thanks to its extremely high speed. A rotating prism transforms the concentrated beam into a shower of light similar to the well known “moon-flower” effect.

Breathtakingly fast movements and effects

Unlike a fixed Par64 ACL, the Alpha Beam 700 is a moving head in all respects: thanks to its three-phase motors, beam movement speed and acceleration are considerably higher, and its reaction time to the control signal is striking.

Absolutely nothing is missing . . .

Needless to say the Alpha Beam 700 also has a CMY mixing system, an eight color wheel plus white, two CTO filters (3,200 K and 2,500 K) and a CTB filter to adjust color temperature, a linear dimmer from 0 to 100% (electronic and mechanical) and a shutter-strobe on a separate channel.

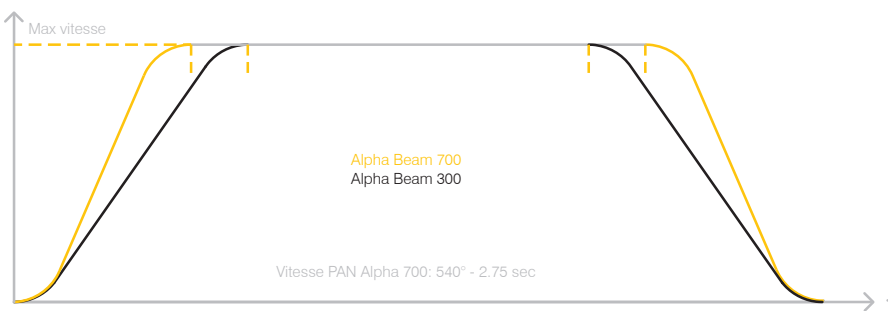
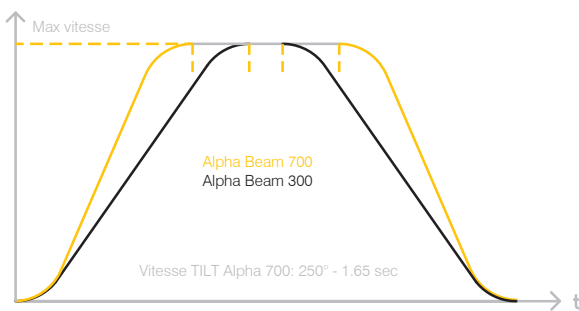

All 700 luminaires reach the maximum speed much quicker than any other light

CONTROL CHANNELS

- | | |
|--------------------------|--------------------|
| 01. Cyan | 14. Linear Frost |
| 02. Magenta | 15. Focus |
| 03. Yellow | 16. Pan |
| 04. Color Wheel | 17. Pan Fine |
| 05. Stop/Strobe | 18. Tilt |
| 06. Dimmer 0-100% | 19. Tilt Fine |
| 07. Dimmer Fine | 20. Function |
| 08. Iris | 21. Reset |
| 09. Static Gobo Change | 22. Lamp control |
| 10. Rotating Gobo Change | 23. Pan -Tilt Time |
| 11. Gobo rotation | 24. Color Time |
| 12. Prism insertion | 25. Beam Time |
| 13. Prism rotation | 26. Gobo Time |

WEIGHT AND DIMENSIONS (mm - inches)

20,8 Kg (45 lbs 12 ozs)

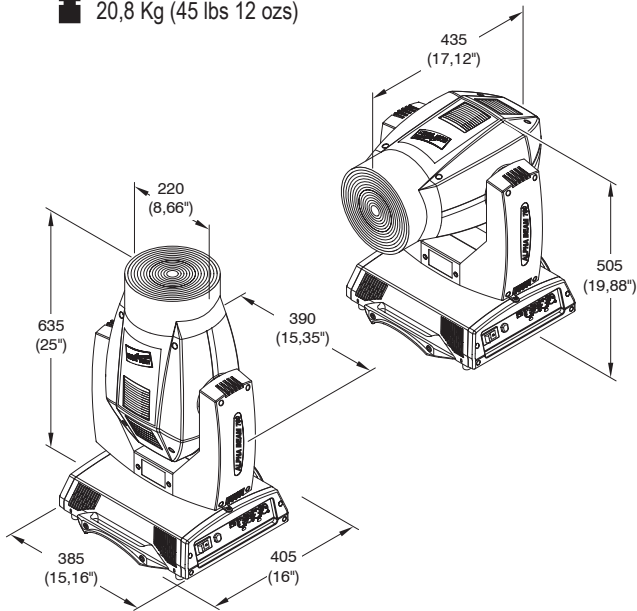

PHOTOMETRICS

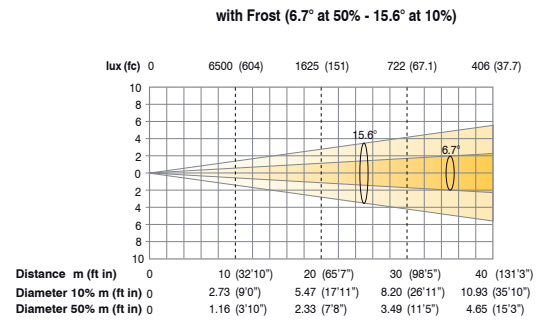
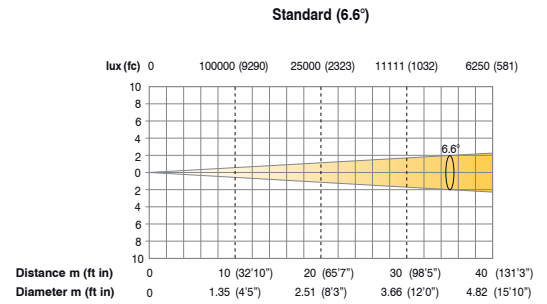

Diameter 10%-50%: beam diameter for 10% and 50% of maximum illumination.

COLOR WHEEL

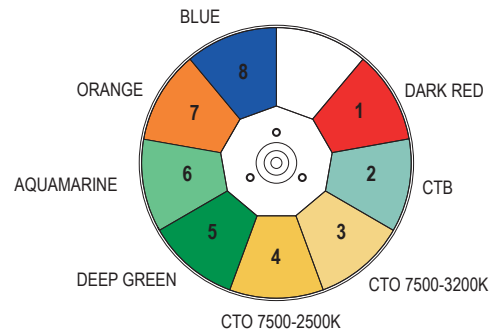

STATIC GOBOS

Ø 31.5 mm

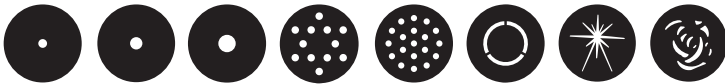

085910/001 085801/001 085802/001 085606/001 085603/001 085909/001 084702/001 085601/001

ROTATING GOBOS

Ø 25.7 mm, image Ø 23 mm



085523/001 085524/001 085525/001 085526/001 085527/001 085528/001 085506/001

ALPHA 700

Profile | Spot HPE | Beam | Wash



light



ALPHA WASH 700

Code C61350

If you are looking for a powerful and - at the same time - small lightweight washlight, the Alpha Wash 700 is the most modern response to your requirements. The new 700W FastFit lamp ensures incomparable brightness for its category. The choice of colors and shades is virtually limitless. An optical unit with extremely high luminous efficiency and a long-range zoom ensure perfect color uniformity at all apertures. Thanks to cutting-edge electronics, movements are accurate and very gentle, and changes in aperture and effects are instantaneous. General operation is extremely silent. Its compact size makes the Alpha Wash 700 virtually invisible on the scene.

An extremely bright uniform field, with aperture that may be adjusted to taste

The Alpha 700 provides about 95,000 lux at five meters in the centre of the beam. The light is well distributed over the whole projection surface. A perfectly linear zoom allows the aperture to be adjusted from 9°-50° and ensures a uniform beam at all distances at the same time maintaining maximum luminous efficiency. The zoom can move instantaneously or be extremely slow and smooth.

An unlimited choice of very beautiful colors

The color generation system consists of a CMY group and one wheel with eight colors + white, with a selection of special colors that are often required in professional lighting use: orange, light green, dark green, aquamarine, lavender, deep

blue (night light effect), and a beautiful saturated red. There is also a CTB filter for adjusting color temperature. Changes from one color to another are instantaneous. A linear CTO device allows color temperature correction from 7500 K to 3200 K, thus greatly widening the color range available and making the light perfectly adaptable to any other light sources found on the scene.

Two rotary beam shapers for changing the shape of the beam

Two special lenses are available to modify beam diffusion: a beam ovalizer and a lens with "diamond tip" effect. Both may be rotated with indexed positioning or rotate continuously with adjustable speed, thus adding an un-usual "fluid" effect (amplifiable with the zoom) to the wash projection.

Motorized top hat

The Alpha Wash 700 features a motorized top hat to eliminate parasite light emissions. It moves in synchrony with the zoom and it disappears automatically inside the fixture's body. The top hat is highly appreciated especially in theatres and television studios; its mechanical sophistication is clear evidence that the Alpha 700 has been designed without compromise.

A highly accurate dimmer

The Alpha 700 Wash dimmer is the most accurate you will ever need. It operates on two dedicated channels (dimmer + dimmer fine). It is electronic from 100 to 50%, i.e. the lamp is dimmed directly thus reducing energy consumption, internal temperature and noise. From 50% to zero dimming is mechanical and linear.



Motorized top hat

CONTROL CHANNELS

- | | |
|----------------------------|--------------------|
| 01. Cyan | 12. Pan |
| 02. Magenta | 13. Pan Fine |
| 03. Yellow | 14. Tilt |
| 04. Linear CTO | 15. Tilt Fine |
| 05. Color Wheel | 16. Function |
| 06. Stop/Strobe | 17. Reset |
| 07. Dimmer 0-100% | 18. Lamp control |
| 08. Dimmer Fine | 19. Pan -Tilt Time |
| 09. Beam shapers insertion | 20. Color Time |
| 10. Beam shapers rotation | 21. Beam Time |
| 11. Linear Zoom | |

WEIGHT AND DIMENSIONS (mm - inches)

20.6 Kg (45 lbs 5 ozs)

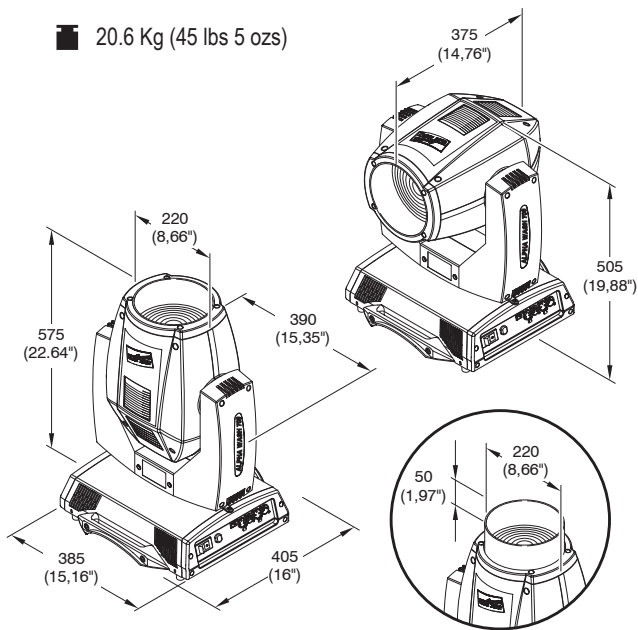

COLOR WHEEL

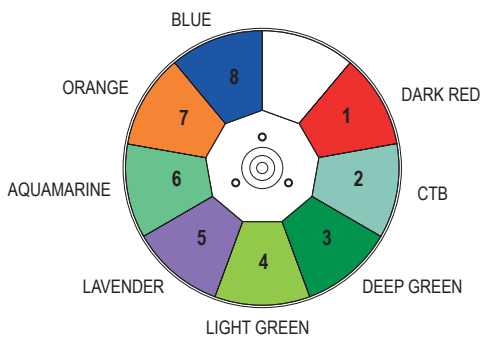

PHOTOMETRICS

Standard (4,1° - 30,0° at 50%; 9,2° - 51,7° at 10%)

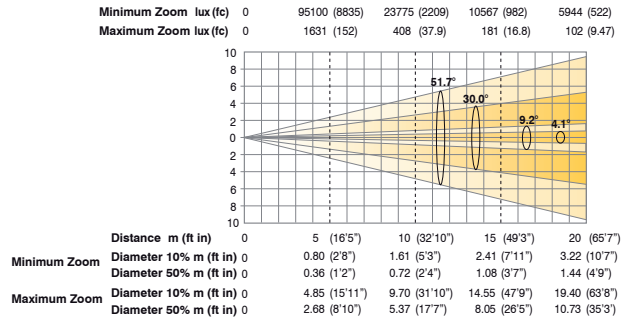

In "Half-Power mode" the luminosity is 58% of the above values

with ovalizer filter (X axis): 10,5° - 35,7° at 50%; 28,8° - 63,2° at 10%

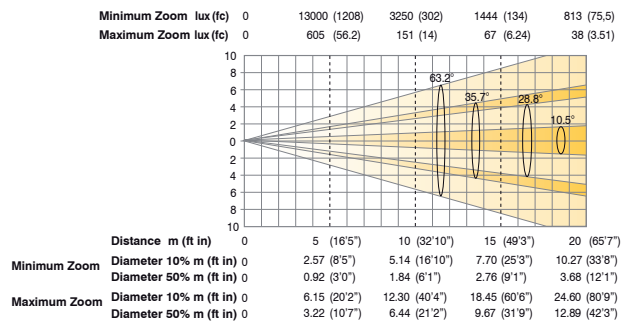

In "Half-Power mode" the luminosity is 44% of the above values

with ovalizer filter (Y axis): 5,3° - 23,6° at 50%; 12,0° - 44,7° at 10%

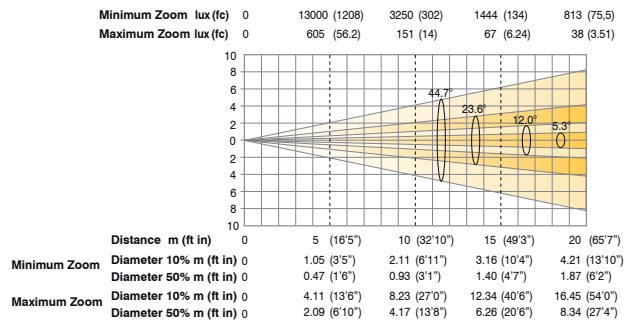

In "Half-Power mode" the luminosity is 44% of the above values

Diameter 10%-50%: beam diameter for 10% and 50% of maximum illumination.

ALPHA 700

Profile | Spot HPE | Beam | Wash



fast



CONSTRUCTION FEATURES

BODY

- Aluminium structure with die-cast composite plastic fireproof cover.
- Two side handles for transportation.
- Device locking PAN and TILT mechanisms for transportation and maintenance.

SAFETY DEVICES

- Bipolar circuit breaker with thermal protection.
- Automatic break in power supply in case of overheating.
- Forced ventilation with axial fans

WORKING POSITION

- Functioning in any position.

LAMP



Code L10098

Philips MSR Gold 700W/2 MiniFastFit Lamp
supplied with the projector

OMEGA

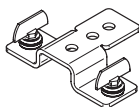

Code 183102/802

for clamps fixing, supplied (2 pieces)

NEW

HIGH QUALITY FLIGHT CASES

for 2 Alpha 700s, equipped with wheels.
They contain 2 foam shells.

Model	Flight Case	Foam Shell
HPE Beam Wash	code F21175	code F21172
Profile	code F21181	code F21177

CE MARKING

In conformity with the European Union Low Voltage Directive 2006/95/CE and Electromagnetic compatibility Directive 2004/108/CE.

MOVING BODY

	Angle	Max speed	Resolution
PAN	540°	3.15 sec (Std) 2.75 sec (Fast)	2.11° (PAN fine=0.008°)
TILT	250°	1.95 sec (Std) 1.65 sec (Fast)	0.98° (TILT fine=0.004°)

Automatic repositioning of PAN and TILT after accidental movement not controlled by control unit.

WEB SERVER

Web Server is an application that opens the entire menu on a computer, providing helpful information such as lamp working hours, software version and other information already directly accessible in the projector menu. It can be used to change DMX address and standard operating options.

Using the Web Server, the firmware can be updated directly from a computer. Just connect the projector to any computer using an Ethernet cable, and follow the instructions (go to www.claypaky.it/en/download and select "web server" in the drop-down menu).



TECHNICAL DATA	ALPHA PROFILE 700	ALPHA SPOT HPE 700	ALPHA BEAM 700	ALPHA WASH 700
Lamp type	700W MiniFastFit	700W MiniFastFit	700W MiniFastFit	700W MiniFastFit
- Color Temperature (K)	7,200	7,200	7,200	7,200
- Luminous Flux (lm)	50,000	50,000	50,000	50,000
- Average Life (h)	750	750	750	750
- Cap	PGJX28	PGJX28	PGJX28	PGJX28
Power supplies available	100-240V 50/60Hz	100-240V 50/60Hz	100-240V 50/60Hz	100-240V 50/60Hz
Input Power	1,050VA at 230V 50Hz	1,050VA at 230V 50Hz	1,050VA at 230V 50Hz	1,050VA at 230V 50Hz
Electronic Ballast	•	•	•	•
Lamp controlled from the Lighting desk	•	•	•	•
Electronic Linear Zoom	11° - 55°	14.7° - 47°		9°-50°
Motorized Top Hat				•
Electronic Focusing	•	•	•	
Stay-Sharp-Zoom (autofocus)	•			
Uniform Field Lens		•		
Dyna-Cue-Creator	•			
CMY color mixing	•	•	•	•
Linear CTO	•			•
Color Wheel	1 (8 colors + white)	1 (8 colors + white)	1 (8 colors + white)	1 (8 colors + white)
CTO filter(s)	1 (2,500K)	2 (2,500K and 3,200K)	2 (2,500K and 3,200K)	
CTB filter			•	•
Linear Frost	•		•	
Fixed Frost		•		
Rotating Gobos (indexable and interchangeable)	7	7	7	
Static Gobos (interchangeable)		8	8	
Morphing Effect		•		
Rotating Prisms	1 (9-facet)	1 (5-facet)	1 (6-facet)	
Framing system	•			
90° rotation of the framing system	•			
Rotating Beam Shapers				• (2)
Mechanical High speed Iris	•	•	•	
0-100% dimmer on a dedicated channel	•	•	•	•
Stop/strobe	•	•	•	•
Long-life self charging battery	•	•	•	•
Preset macros	•	•	•	•
Function reset from control unit	•	•	•	•
"Autotest" routine	•	•	•	•
Ethernet-ready	•	•	•	•
Web server connectivity	•	•	•	•
Electronic monitoring of all parameter status with Error alarm	•	•	•	•
Cooling system monitoring	•	•	•	•
DMX level monitoring on all channels	•	•	•	•
Internal data transmission diagnostics	•	•	•	•
Firmware upgrade with no need of connection to power	•	•	•	•
Firmware upload from another fixture	•	•	•	•
Switchable Power supply	automatic	automatic	automatic	automatic
PAN and TILT lock on 4 and 7 positions respectively	•	•	•	•
Silent Version (SV)	•	•	•	•
DMX control channels	max 41	max 29	max 26	max 21
Weight (Kg/lbs)	31,5 (69 lbs 5 ozs)	22,9 (50 lbs 6 ozs)	20,8 (45 lbs 12 ozs)	20,6 (45 lbs 5 ozs)
Dimensions LxWxH (mm/inches)	385x405x650 (15.16"x16"x25.6")	385x405x615 (15.16"x16"x24.01")	385x405x635 (15.16"x16"x25")	385x405x575 (15.16"x16"x22.64")

ALPHA 700

Profile | Spot HPE | Beam | Wash

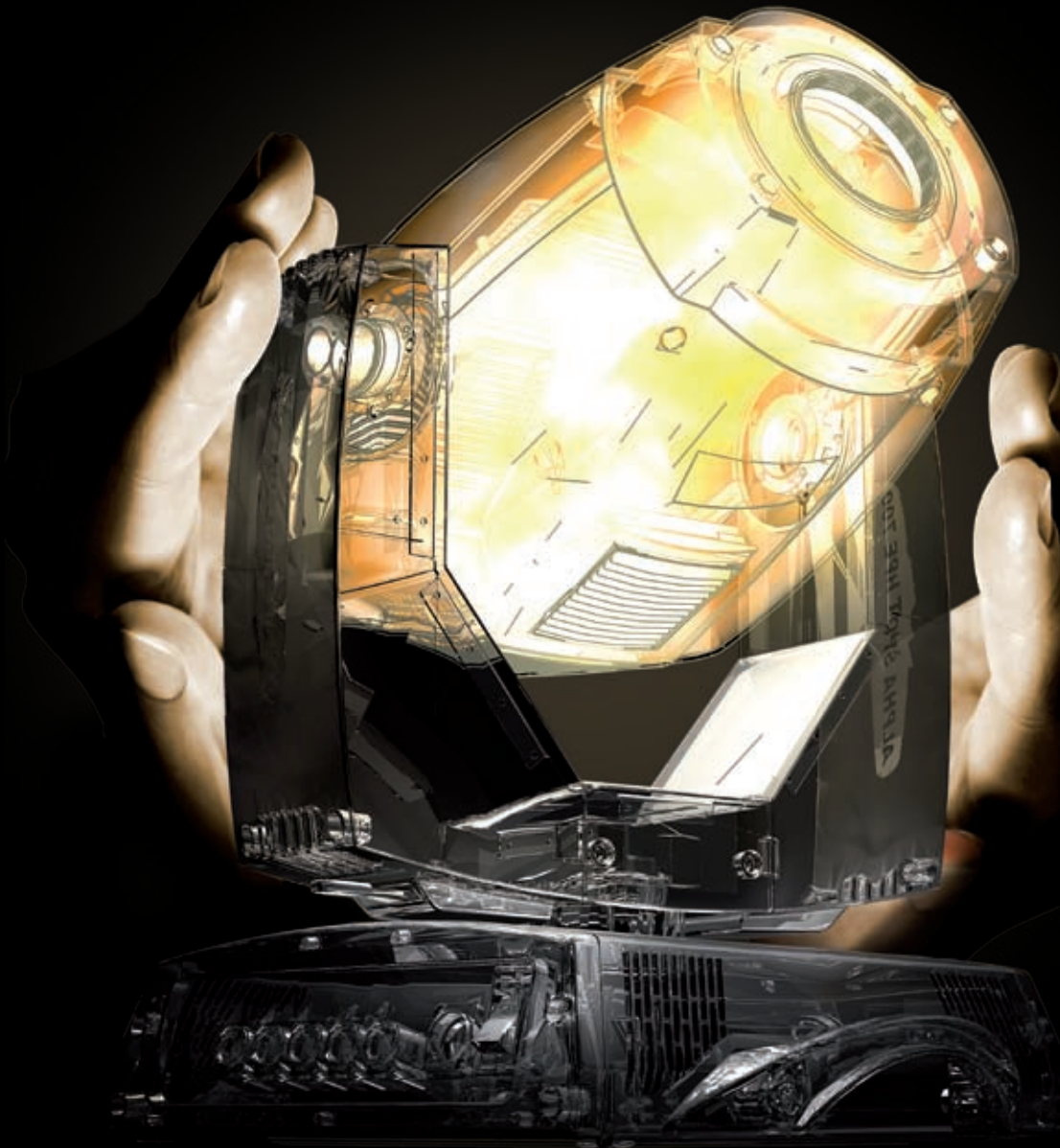

bright



www.claypaky.it

CLAY PAKY S.p.A.
I - 24068 Seriate (BG) - Via Pastrengo, 3/b
Phone +39 035 654311 - Fax +39 035 301876
www.claypaky.it - cp.info@claypaky.it



UNI EN ISO 9001